

perfectly connected

Conception Bay South INDUSTRIAL PARK





Conception Bay South Industrial Park is ideally located for you and your business.

The perfect position within the greater St. John`s metropolitan area, Conception Bay South Industrial Park provides a unique purchasing opportunity with strategic and convenient access to all major transportation routes.

The zoning of the Conception Bay South Industrial Park allows for a diverse range of logistics operations, warehousing, industrial manufacturing and service industries.

Conception Bay South
INDUSTRIAL PARK



Conveniently located on the boundary of St. John's and Conception Bay South.

76 acres of commercial light industrial zone.

Lot sizes range from 1 to over 10 acres.

Fully serviced water and lot contained septic systems.

Lot preparation can be tailored to suit your need. Range from grubbed off to fully engineered pads.

Direct access to the Conception Bay South Highway

5.6 KM to the TCH

24 KM to downtown St. John's

25 KM to St. John's International Airport

3 KM to Long Pond Port

36 KM to Bay Bulls

99 KM to Long Harbour

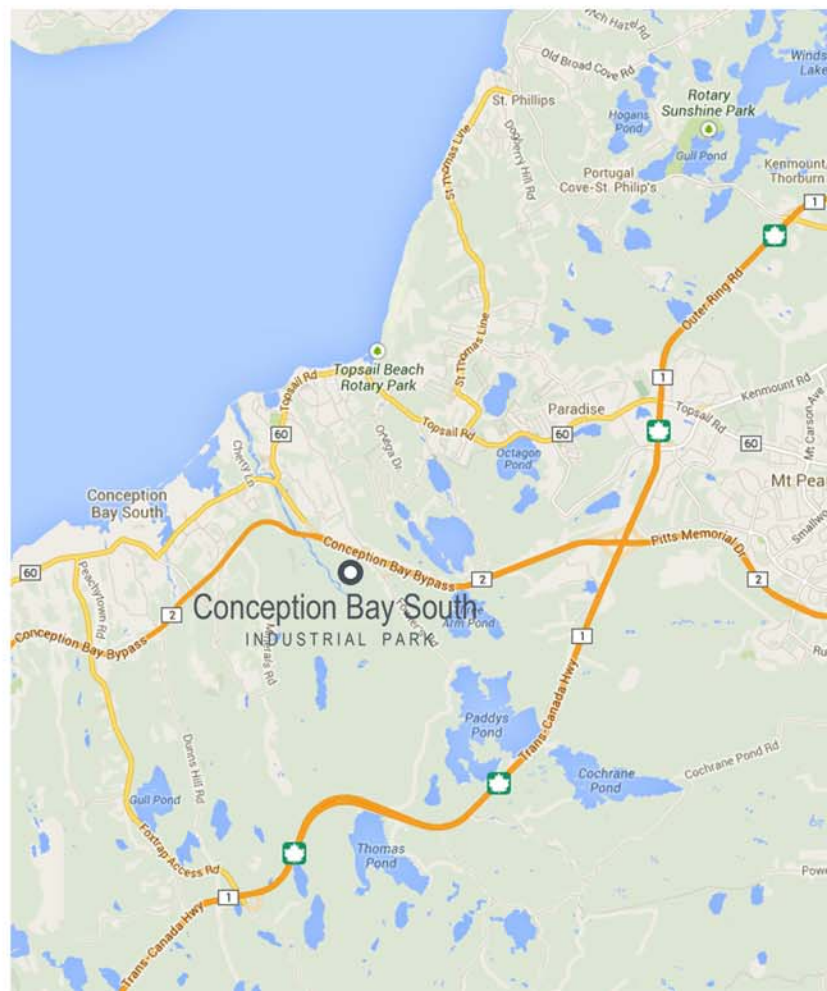

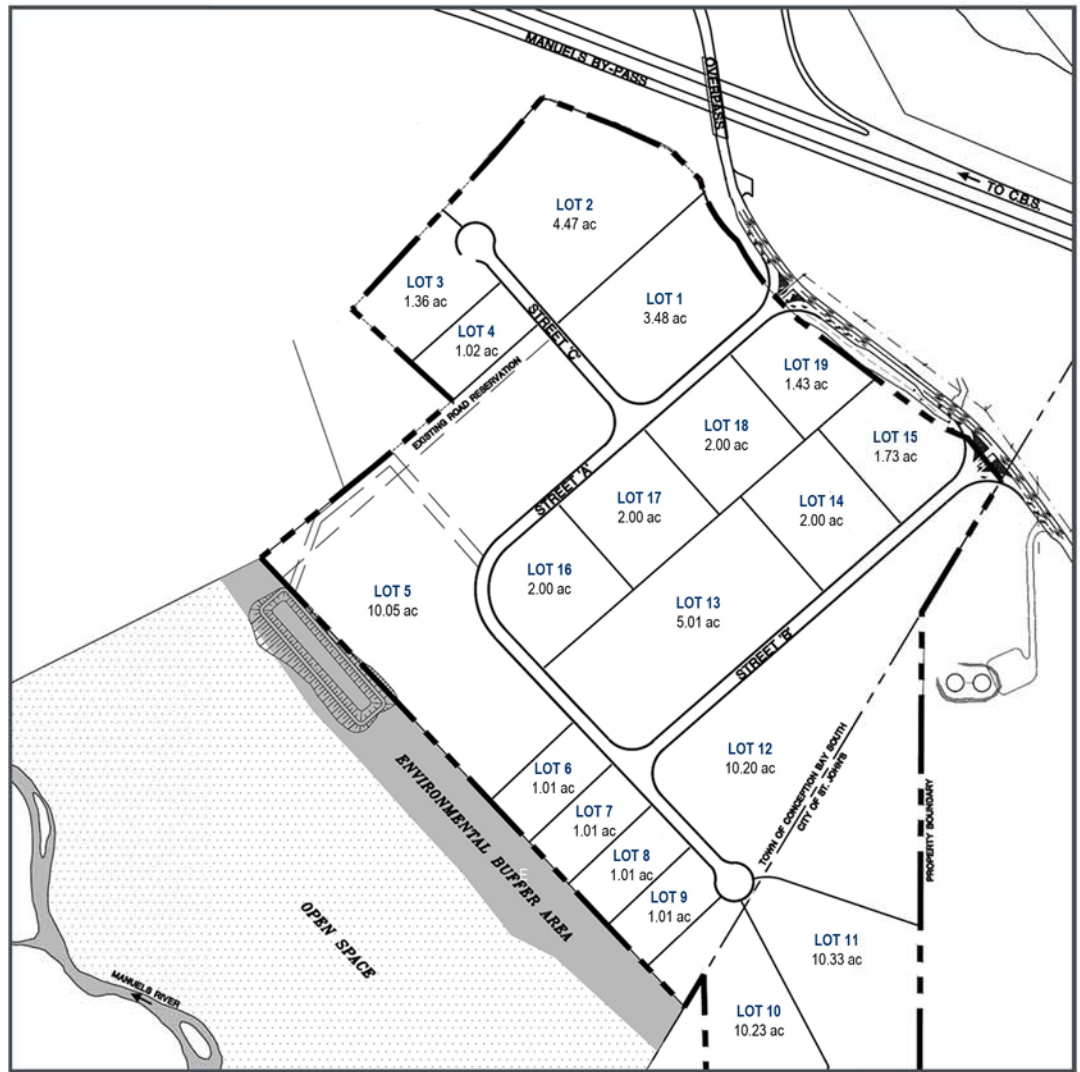

Available Lots and Sizes

Metcalfe Holdings Limited

15 Wylies Place
 Conception Bay South, NL
 A1W 4V6

T 709 834 2963
 F 709 834 1080

Metcalfe Holdings is a family-owned company that specializes in the development of industrial and commercial spaces.

For all enquiries regarding Conception Bay South Industrial Park, please contact:

Keith Maher
 keith@cbsindustrialpark.com
 C 709 682 2217

Jason Metcalfe
 jason@cbsindustrialpark.com
 C 709 330 3122

Conception Bay South
 INDUSTRIAL PARK

www.cbsindustrialpark.com